

# EKO5600

API CLASS 150-600 SWING CHECK VALVE



## TECHNICAL ADVANTAGES

- Valve design according to ASME B16.34 MSS SP-42
- Face to face length according to ASME B16.10 & ISO 5752
- Flanged connection according to ASME B16.47-BS3293 MSS SP-44
- Butt weld Dimensions according to ASME B16.25
- Visual Inspection according to MSS SP-55
- Marking According to MSS SP-55
- Valve test according to API 598-BS6755 Part 1 and MSS SP-61
- EKO5600 Series swing check valves are completely suitable for potable water networks Potable Water, Cold and hot water systems, any fluid without acidity or alkalinity
- Max Application Temperature +130°C
- Non-Return valve
- Available in Big Sizes (Please ask for data sheets)

## MATERIAL

- Stud: A193 Gr B7, A194 Gr 2H
- Cover Nut: A193 Gr B7, A194 Gr 2H
- Cover: A216 Gr WCB
- Washer: SS410
- Gasket: SS304+Graphite
- Hinge Yoke: A216 Gr WCB
- Pin: SS410
- Hinge: A216 Gr WCB
- Pocket Pin: SS410
- Disc Nut: A194 2H
- Disc: A105+13%Cr
- Seat Ring: A105+13%Cr, SS316, SS304



## COATING

- Inner and outer surface of the valve is powder epoxy (250-350 Microns) coated

## VERSIONS

- Can be supplied with Lever (Please ask for a quotation)
- Counterweight can be adapted to this model

Remarks: Grey tones represents available options.

# EKO5600

## API CLASS 150-600 SWING CHECK VALVE

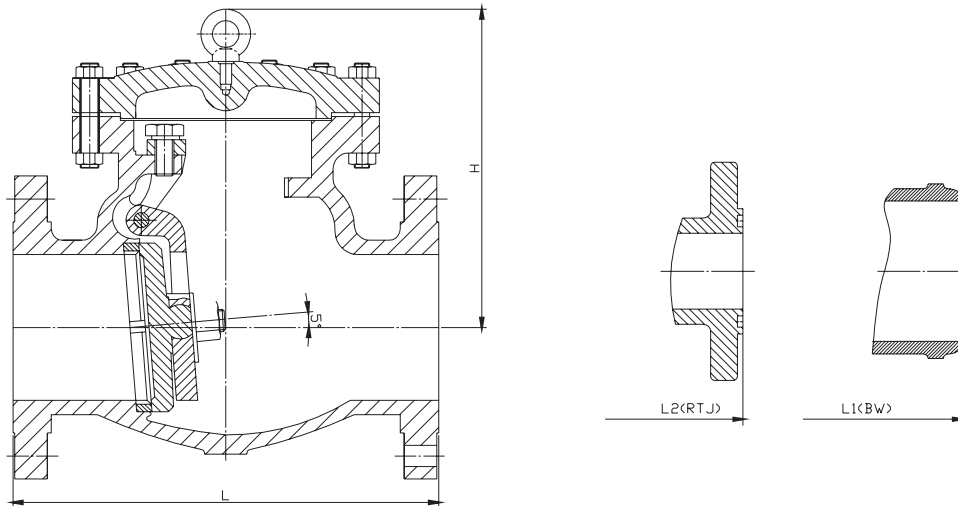

**API Class 150-600 Swing Check Valve Dimension Class 150**

Size	inch	2	2 1/2	3	4	5	6	8	10	12	14	16	18	20	24
L, L1-RF, BW	mm	203	216	214	292	220	356	495	622	699	787	864	978	978	1295
L2-RTJ	mm	216	229	254	305	343	368	508	635	717	800	876	1991	1991	1308
H	mm	155	190	200	225	245	260	350	390	410	435	530	570	625	675
WT. (App.)	kg	16	25	34	46	75	89	120	220	337	471	575	788	916	1275

**API Class 150-600 Swing Check Valve Dimension Class 300**

Size	inch	2	2 1/2	3	4	5	6	8	10	12	14	16	18	20	24
L, L1-RF, BW	mm	267	292	318	355	400	440	533	622	711	838	863	977	1016	1346
L2-RTJ	mm	283	308	333	371	416	460	549	638	727	854	879	994	1036	1358
H	mm	180	200	225	240	275	310	370	410	440	500	545	605	675	785
WT. (App.)	kg	26	32	53	73	110	157	234	384	450	650	800	970	1350	2210

**API Class 150-600 Swing Check Valve Dimension Class 600**

Size	inch	2	2 1/2	3	4	5	6	8	10	12	14	16	18	20
L, L1-RF, BW	mm	292	330	356	432	508	559	660	787	838	889	991	1092	1194
L2-RTJ	mm	295	333	359	435	511	562	664	791	841	892	994	1095	1200
H	mm	190	215	250	260	310	350	420	490	525	580	630	690	810
WT. (App.)	kg	33	49	62	95	120	195	360	465	725	875	1075	1475	1900

Remarks: Lever/counter weight adoptable for this model.

Remarks: Higher pressure classes also available.