

EKO2600

API CLASS 150-300 OS&Y GATE VALVE



TECHNICAL ADVANTAGES

- Valve Design According to API 600 & ISO 10434 - ASME B16.34-BS 1414
- End to End Dimensions According to ASME B16.10 & ISO 5752
- Flange Dimensions According to ANSI B16.10-ASME B16.47-BS3293
- Butt weld Dimensions According to ASME B16.25
- Visual Inspection: MSS SP-55
- Valve Test According to API 598 & ISO 5208-MSS SP-61
- EKO2600 Series Gate Valves Are Suitable For Heavy Duties such as Boiler Facilities and Rough Surroundings.
- Minimal Leakage, Long Service Life
- Effective Stream Separation in Either Direction of The Valve
- Outside Screw and Yoke Design
- Seat Rings and Wedge Disc Ground and Lapped to a Mirror Finish to Provide Matching Sealing Surfaces
- Wedge Disc Fully Guided and Precision Fitted to Ensure Tight Sealing Performance
- Machined Backseat Bushing to Provide a Secondary Metal-Metal Stem Seal
- Grease Fitting for Yoke Sleeve Lubrication to minimize Operating Torque & Stem Wear
- Bolted Bonnet Construction

MATERIAL

- Body: A216 WCB LCB, CF8
- Bonnet: A216 WCB LCB, CF8
- Stem: A182 F6a, A182 F316, A182 304
- Wedge: A216 Gr WCB+13Cr, SS304, SS316 LCB, CF8
- Gland: 1045
- Gland Flange: Carbon Steel, Equivalent to Body Material
- Seat Ring: A105 B+ overlay
- Stud: A193 B7
- Nut: A194 Gr 2H
- Back Seat: SS410
- Gland Eye Bolt: A193 B7



COATING

- Please ask for options

VERSIONS

- Flanged or Butt weld ends
- OS&Y Rising Stem and Non-Rising Stem Versions Available
- Ready For Electric Actuator
- With Electric Actuator
- With Handwheel
- With Telescopic or Rigid Extension Spindle
- 2Cr13 as Standard
- With Limit Switches or Position Indicators
- With Operation Cap & T-Key

Remarks: Grey tones represents available options.

EKO2600

API CLASS 150-300 OS&Y GATE VALVE

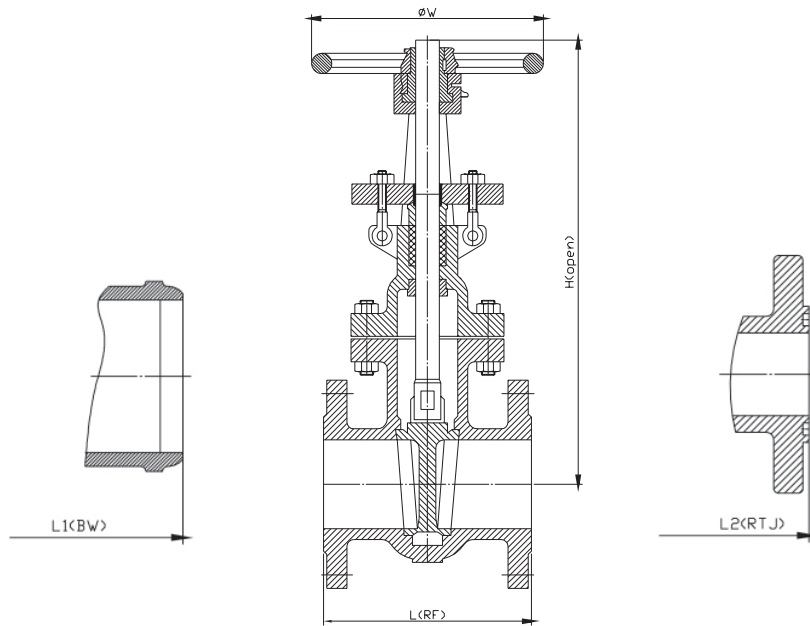

Class		API Class 150-300 OS&Y Gate Valve Dimensions Table														
150	Size	inch	2	2 1/2	3	4	6	8	10	12	14	16	18	20	24	
	L-RF	mm	178	191	203	229	267	292	330	356	381	406	432	457	508	
	L ₂ -BW	mm	216	241	283	305	403	419	457	502	572	610	660	771	813	
	L ₂ -RTJ	mm	191	203	216	241	279	305	343	368	394	419	445	470	521	
	H	mm	400	490	510	585	795	1015	1230	1465	1755	2030	2210	2510	2880	
	W	mm	200	200	250	300	350	350	400	450	500	500	600	750	750	
	Wt	RF	kg	18	28	30	50	85	128	220	310	450	550	700	810	1130
		BW	kg	15	22	26	40	77	118	200	290	435	510	650	880	1100
		RTJ	kg	20	29	37	56	84	138	210	310	450	565	740	927	1125
300	Size	inch	2	2 1/2	3	4	6	8	10	12	14	16	18	20	24	
	L-RF	mm	216	241	283	305	403	419	457	502	762	838	914	991	1143	
	L ₂ -BW	mm	232	257	298	321	419	435	473	518	778	854	930	1010	1165	
	L ₂ -RTJ	mm	232	257	298	321	419	435	473	518	778	854	930	1010	1165	
	H	mm	470	525	533	610	845	1050	1295	1600	1830	2035	2195	2470	2900	
	W	mm	200	200	250	300	350	350	400	450	500	500	600	750	750	
	Wt	RF	kg	20	35	37	54	110	174	285	495	615	940	1090	1500	2100
		BW	kg	24	44	48	73	145	226	350	580	715	1050	1235	1655	2320
		RTJ	kg	24	44	48	73	145	226	350	580	715	1050	1235	1655	2320
600	Size	inch	2	2 1/2	3	4	6	8	10	12	14	16	18	20	24	
	L-RF	mm	292	330	356	432	559	660	787	838	889	991	1092	1194	1397	
	L ₂ -BW	mm	295	333	359	435	562	664	791	841	892	994	1095	1200	1407	
	L ₂ -RTJ	mm	295	333	359	435	562	664	791	841	892	994	1095	1200	1407	
	H	mm	495	550	615	735	1005	1245	1480	1730	1915	2050	2260	2620	2900	
	W	mm	200	250	300	350	450	500	600	750	850	850	960	960	1000	
	Wt	RF	kg	32	47	64	103	218	374	570	830	1012	1217	1760	2000	3200
		BW	kg	35	55	72	126	365	444	700	940	1310	1610	2070	2405	3810
		RTJ	kg	35	55	72	126	365	444	700	940	1310	1610	2070	2405	3810