

EKO16000

ELECTROMAGNETIC FLOWMETER



TECHNICAL ADVANTAGES

- High Accuracy- Thanks to our High SNR Flow Sensor and Measurement Circuitry
- Transmitter Housing made of Casted Aluminium Supporting Multiple Communication Protocols as HAR Modbus RS-485
- Optimized for low Flow Measurement, rated accuracy holds to 0,1 m/s Flow Speed
- Measured variable: Volume flow rate by flow speed
- Measuring range: 0.005- 10 m /s
- Measuring performance: 0.5 %
- 0.2 % / 0.3 % o.R. Up on request for special calibration
- Supply Voltage: 85~265 VAC or 24 VDC
- Power consumption: 10 W
- Temperature: 0~60° C
- Pressure rating: DN50 ~ DN150 16bar (1.6Mpa or 230 psi)
- DN200 ~ DN450 10bar (1.0Mpa)
- Min. Conductivity: 10µs /cm
- Connection: ANSI C16.5 #150
- Output signal Analog: Active 4 ~ 20mA output
- Pulse Output: Active
- Frequency output 0 ~ 5 kHz,50 % duty cycle
- Communication Modbus RS-485 or HART (optional)

MATERIAL

- Transmitter housing made of casted aluminium
- Sensor Material: 316 Stainless Steel
- Electrodes: 316 Stainless Steel
- Sealing O-Rings : EPDM
- Electronics Housing : Casted Aluminium
- Sensor Body: Carbon Steel
- Flow Tube: 304 Stainless Steel
- Liner :CR



COATING

- Electronics Housing Powder Coated

VERSIONS

- Compact Type
- Remote Type
- Clamp Type
- Thread Type
- Wafer Type
- Insertion Type

EKO16000

ELECTROMAGNETIC FLOWMETER

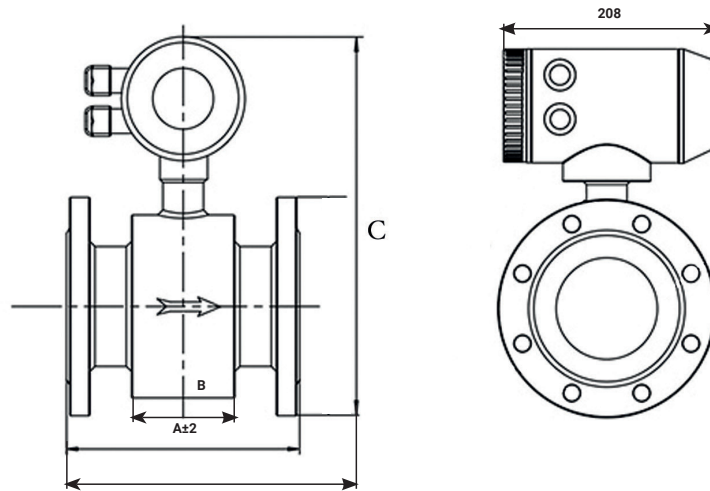

Electromagnetic Flowmeter Dimension Table

| DN | Inch | B(mm) | A±2(mm) | C(mm) |
|-----|------|-------|---------|-------|
| 50 | 2 | 102 | 200 | 349 |
| 80 | 3 | - | - | 380 |
| 100 | 4 | 122 | 250 | 401 |
| 125 | 5 | 132 | 250 | 428 |
| 150 | 6 | 170 | 300 | 462 |
| 200 | 8 | 202 | 350 | 510 |
| 250 | 10 | 222 | 400 | 567 |
| 300 | 12 | 312 | 500 | 620 |
| 350 | 14 | 312 | 500 | 676 |
| 400 | 16 | 392 | 600 | 731 |
| 450 | 18 | 402 | 600 | 787 |